

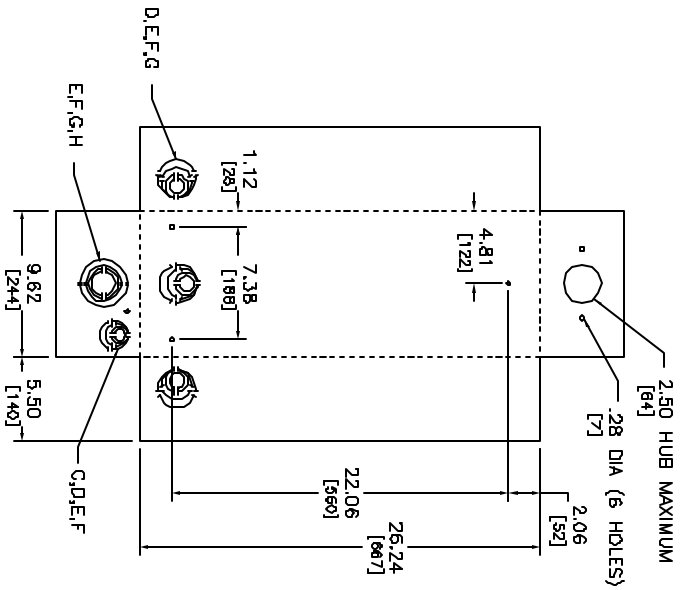

KNOCKOUTS								
SYMBOL	C	D	E	F	G	H		
IN	1.00	1.25	1.50	2.00	2.50	3.00		
MM	25	32	38	51	64	76		



DUAL DIMENSIONS: INCHES
MILLIMETERS

SERVICE	AMPERE RATING	RAINFOOF NEMA TYPE 3R	CIRCUIT BREAKER (ORDER SEPARATELY)		UL LISTED INTERRUPTING RATING RMS SYM. AMPERES	TERMINAL LUGS WIRE SIZE AWG/CL	NEUTRAL ASSEMBLY TERMINAL LUG WIRE SIZE AWG/KOMIL	
			CATALOG NUMBER	UL LISTED RATING RMS SYM. AMPERES			NEUTRAL TERMINALS	GROUNDING TERMINALS
TWO POLE  240VAC	100-225A	Q2-3225NIRB	Q2L	10,000	#4-300	#4-300 AL/CL	#12-1/0 AL OR #4-1/0 CL	
			Q2L-H	22,000				
			QBL QDL QGL QJL	10,000 25,000 85,000 100,000				
THREE POLE  240VAC	100-225A	Q2-3225NIRB	Q2L	10,000	#4-300	#4-300 AL/CL	#12-1/0 AL OR #4-1/0 CL	
			Q2L-H	22,000				
			QBL QDL QGL QJL	10,000 25,000 85,000 100,000				

Q2 LOAD CENTERS
RAINFOOF ENCLOSURE
ENCLOSED CIRCUIT BREAKER DEVICES

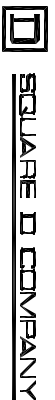

QMC# 328B

- NOTES:
 FINISH - GRAY BAKED ENAMEL, ELECTRODEPOSITED OVER CLEANED PHOSPHATIZED STEEL.
 UL LISTED - FILE E-136861
 NEUTRALS - INSULATED GROUNDABLE
 + EQUIPMENT GROUND KIT FACTORY INSTALLED.
 ▲ WHEN INSTALLED IN ENCLOSURES THE MAXIMUM AIR IS 65,000 AT 240V AND 100,000 AT 208V.