

Developing what you need, delivering what you want

# The **DU•ALL™** Dual Drain Washing Machine Outlet Box Featuring **EZ•Out™** Test Cap

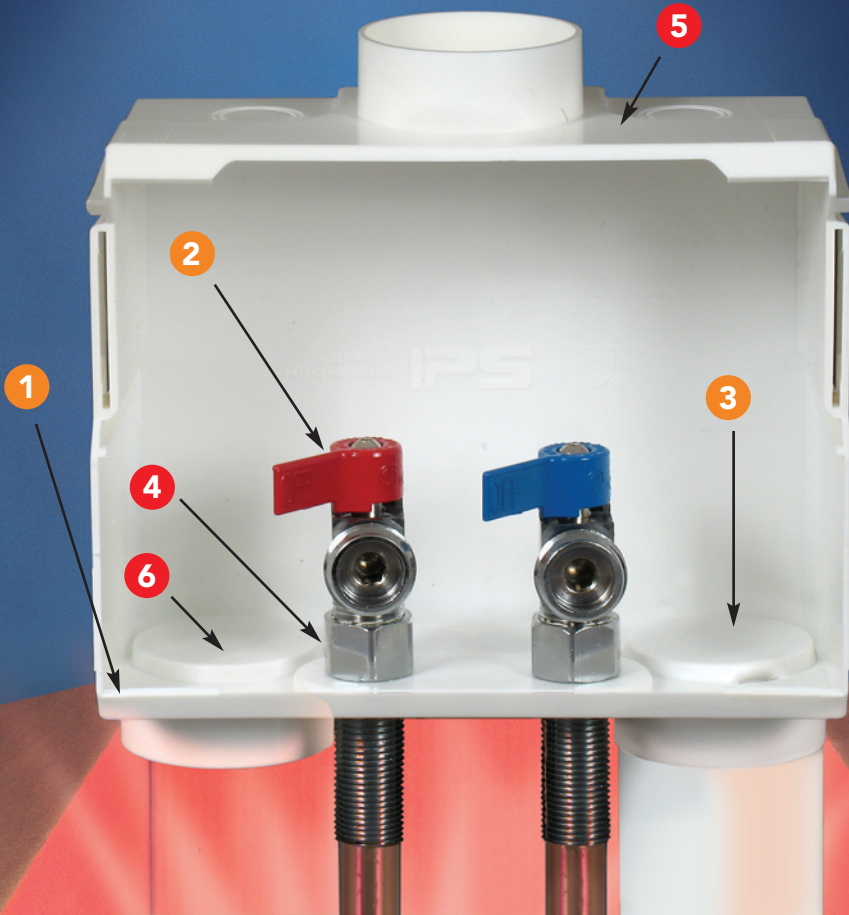

**WATER TITE**  
IPS CORPORATION

## Standard Washer Box Features:

- Our one piece design speeds installation vs separate drain and valve boxes
- Depth of the box rests against the back sheetrock wall for sturdy installation
- Side of the box has a flat side for secure mounting to wall
- The frame is interchangeable with center drain washing machine outlet boxes

## Key Dual Drain Features:

- 1 Solid one piece construction with raised drip guard contains and sends valve or washing machine hose leaks down the drain
- 2 Forward mounted valves give easy access to homeowners for on/off operation
- 3 Drains positioned toward back of box for connection to trap from either side

## Added Du•All Dual Drain Features:

- 4 Various valve mounting options allows dual drain, right drain only or left drain only
- 5 Box can be inverted for top mount valves/center drain option
- 6 EZ Out Test caps are raised for EZ removal and KO's are oversize so they won't fall down the drain

**IPS**  
CORPORATION

500 Distribution Parkway, P.O. Box 220, Collierville, TN 38027, USA  
TEL: 901-853-5001 ■ WATS: 800-888-8312 ■ FAX: 901-853-5008

Web Site: [www.ipscorp.com](http://www.ipscorp.com)  
E-Mail: [watertite@ipscorp.com](mailto:watertite@ipscorp.com)

# The **DU•ALL™** Dual Drain

Design Gives Flexibility of Valve Mounting Options

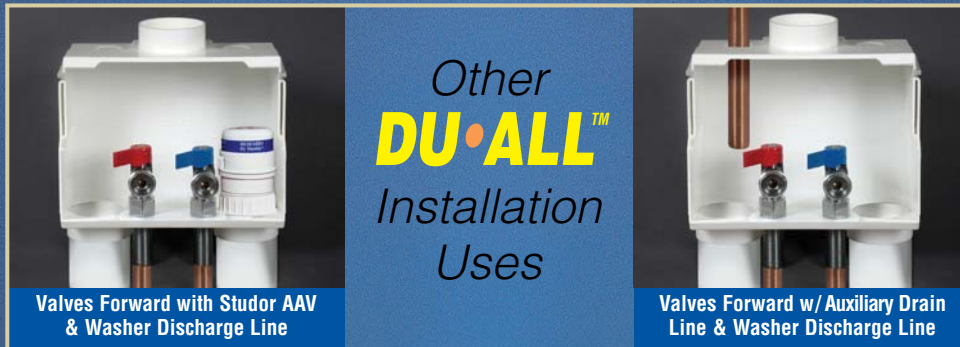
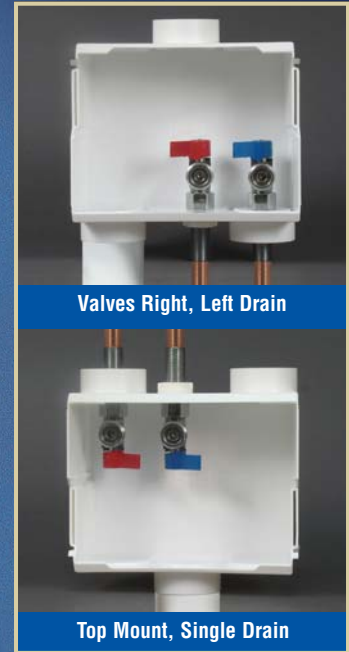
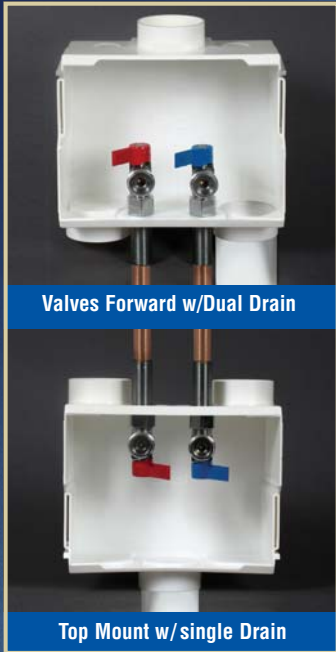

## **EZ•OUT™** Test Caps Are Raised Up for EZ Removal

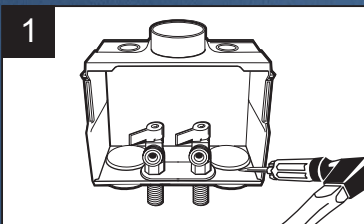

Position flathead screwdriver at intersection of bottom wall and raised test cap.

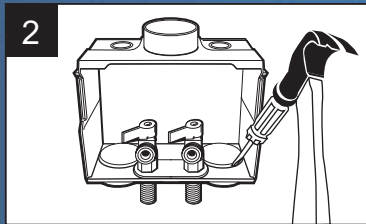

Hit screwdriver until it penetrates under test cap.

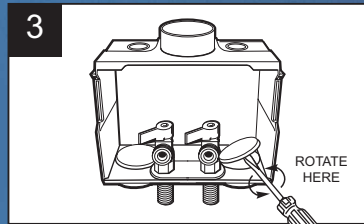

Rotate screwdriver lifting up test cap.

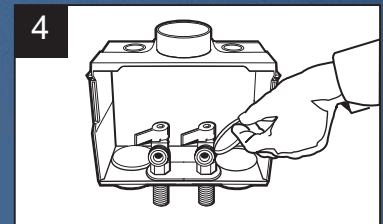

Reach in with hand or pliers and remove test cap.

KITEC® is a registered trademark of IPEX, Inc.

### VALVE CONNECTIONS

ProPEX® is a registered trademark of Uponor/Wirsbo

