

www.schneider-electric.com
W9 1378322 0211 A07
06 - 2016

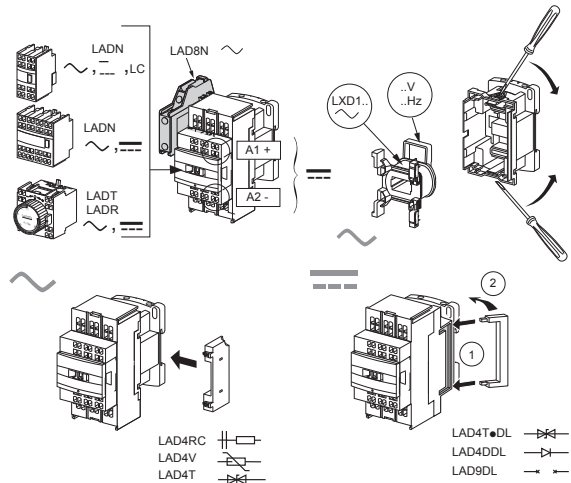
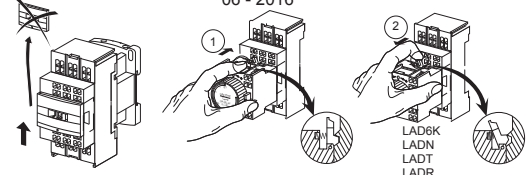

▲ ▲ DANGER / 危险
HAZARD OF ELECTRIC SHOCK, EXPLOSION, OR ARC FLASH
 Disconnect all power before servicing equipment.
 Failure to follow these instructions will result in death or serious injury.
 可能有触电、爆炸或电弧灼伤危险。
 在此电力设备上进行操作时，请先断开所有电源。
 不遵循上述规定将可能导致人员伤亡。

					AWG	
		[mm]	[mm ²]	[mm ²]		[mm]
d	LC1D093/D123/ DT203/D0983	10 mm 3/8"	1...2.5	1...2.5	AWG14-18 CU 75°C Solid or Stranded	3,5 mm
	LC1D183/D253/ DT253/D1283	10 mm 3/8"	1...4	1...4	AWG10-18 CU 75°C Solid or Stranded	4 mm
	LC1D323	10 mm 3/8"	1...4	1...4	-	4 mm
d	LC1DT323/DT403/ D1883/D2583	13 mm 1/2"	1...10	-	AWG10-14 CU 75°C Solid AWG8-14 CU 75°C Stranded	4 mm
	LC1D●●3	8 mm 5/16"	1...2.5	1...2.5	AWG14-18 CU 75°C Solid or Stranded	3,5 mm

"For Motor Starting Use Schneider Electric Overload Relay Series LR".
 电动机启动请使用施耐德电气LR系列热过载继电器

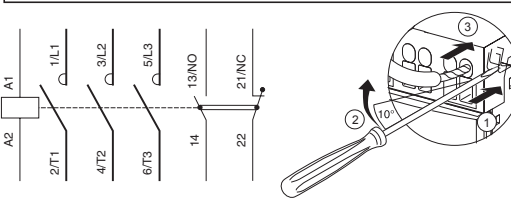

3P AC TeSys D contactors are grade 3 (LC1D09 -> LC1D18) and grade 2 (LC1D25 -> LC1D38) according to GB 21518. Maximum power consumption lower than 9.5 VA.
 根据GB 21518标准，三级 TeSys D 系列交流接触器能效等级为3级 (LC1D09 -> LC1D18) 和2级 (LC1D25 -> LC1D38)，产品最大功耗低于9.5VA

Schneider Electric Industries SAS
 35 Rue Joseph Monier
 92506 Rueil Malmaison, France

