

Assembly Instructions

TB150BG Heavy-Duty Carbon Steel Tow Behind Salt Spreader, Bulk Flow Gate

Check contents of box against the parts list to make sure all components are included. When ordering replacement or spare parts refer to the parts list for part numbers.

TOOLS NEEDED FOR ASSEMBLY

- (2) 10mm Wrenches
- (2) 1/2 in Wrenches



DO NOT TOW faster than 3mph

ASSEMBLE THE AXLE COMPONENTS – FIGURE 1

A. Install the Gearbox, Hopper Frame tubes, Bushings and Wheels onto Axle

B. Install the Spinner Disc onto the Gearbox

ASSEMBLE THE LOWER FRAME AND HOPPER – FIGURE 2

C. Attach the Lower Frame tubes with the Hopper Frame tubes.

D. Install the Hopper onto the Hopper Frame tubes. (The Printed Logo should be same side as Hopper Tube Ends)

ASSEMBLE THE TOWING FRAME, TOWING BRACKETS AND CONTROL TUBE – FIGURE 3

E. Attach the Towing Frame tube to the Lower Frame

F. Attach the Towing Brackets to the end of the Towing Frame

G. Attach the Control Frame to the Towing Frame using the Frame Connector

ASSEMBLE THE LINKAGE PLATE ASSEMBLY AND LOWER LINKAGE – FIGURE 4

H. Carefully insert the short leg end of the Lower Linkage into the Restrictor Plate underneath the Hopper as shown. (The Lower Linkage has two bent ends & the Upper Linkage has one threaded end)

I. Insert the other end of the Lower Linkage into the front hole on the Linkage Plate Assembly

J. Attach the Linkage Plate Assembly and Handle to the Frame using two M6x40 bolts as shown.

K. Frame tube to the Lower Frame with the Hopper Frame tubes.

L. Carefully insert the Lower Linkage into the Restrictor Plate underneath the Hopper as shown. (The Lower Linkage has two bent ends & the Upper Linkage has one threaded end)

NOTE: The Lower Linkage must be attached to the restrictor and the Linkage Plate Assembly before the Assembly is attached to the frame. If the Linkage Plate Assembly is attached to the Frame without the Lower Linkage, the Lower Linkage will be very difficult to assemble and may cause the restrictor plate to be broken during assembly.



ATTACH CONTROL HANDLE ASSEMBLY, UPPER LINKAGE, & REAR DEFLECTOR – FIGURE 5 & 6

M. Mount the Control Handle Assembly to the Control Frame using two M6x40 bolts as shown.

N. Insert the Upper Linkage into the Control Handle as shown

O. Thread one Jam Nut so that the Restrictor Plate underneath the Hopper is fully closed when the Control Handle is at "30".

P. Assemble the second jam nut in this position to lock the linkage in place.

Q. Verify that the Restrictor Plate may be fully opened by pushing the Control Handle forward.

R. Attach the rear deflector.

FINAL ASSEMBLY

T. Check And Tighten All Fasteners – Make sure the Gearbox turns freely when pushing and pulling the unit.

U. Place the Screen in the hopper.

V. Install the Rain Cover on the hopper.

OPERATION

1. Before filling Hopper, ensure that the Restrictor Plate is fully closed and the screen is in place.

2. Move and tighten the stop bolt to the desired setting.

3. Begin moving forward with the spreader.

4. Pull the Control Handle back to the stop bolt to open Restrictor Plate and allow material to flow.

5. Before stopping, push the Control Handle fully forward to stop flow.

MAINTENANCE

1. The Hopper and Spinner should be completely emptied and cleaned before storage.

2. The Spreader should be washed and dried before storage.

3. Check that the Restrictor Plate and Linkage move freely. Clear out any debris between the Restrictor Plate & the Hopper.

4. Check that there is no debris in the Gears & that they move freely.

5. Check torque of all fasteners on a monthly basis.

OPERATION NOTES:

1. The spreader is designed to be operated between 2-3 mph. DO NOT TOW faster than 3mph.

2. Grease may be applied to the Gearbox as desired.

Figure 1

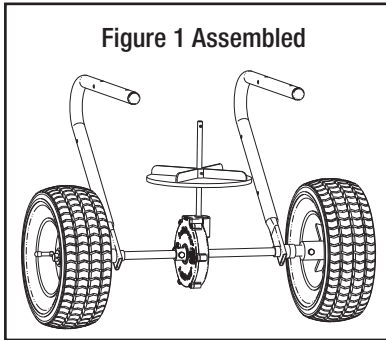
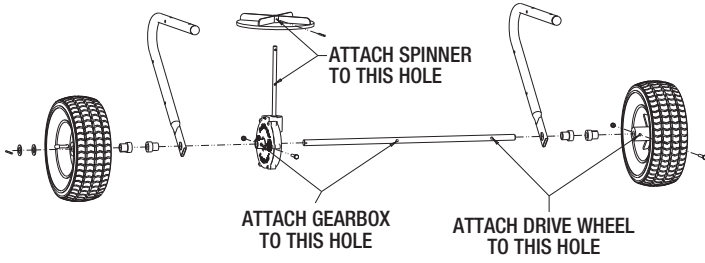

Figure 2

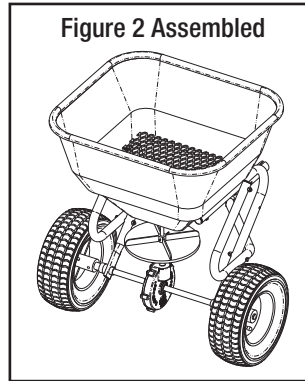
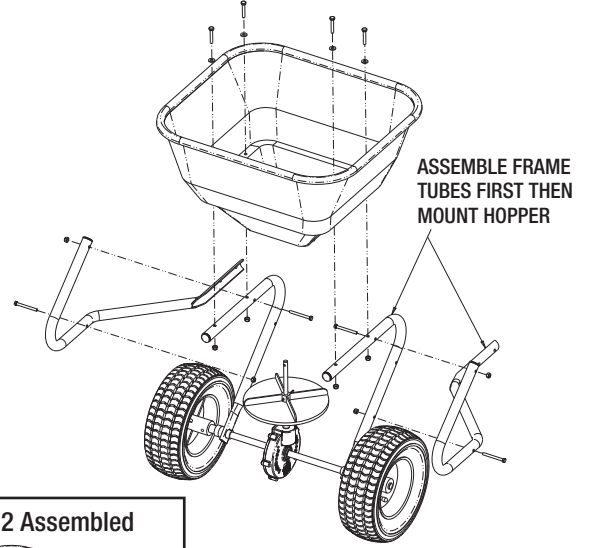

Figure 3

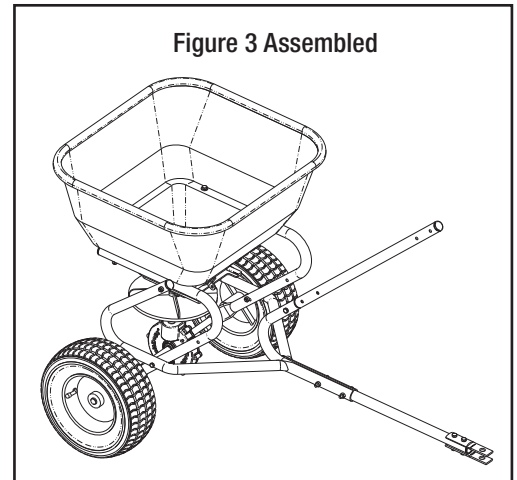
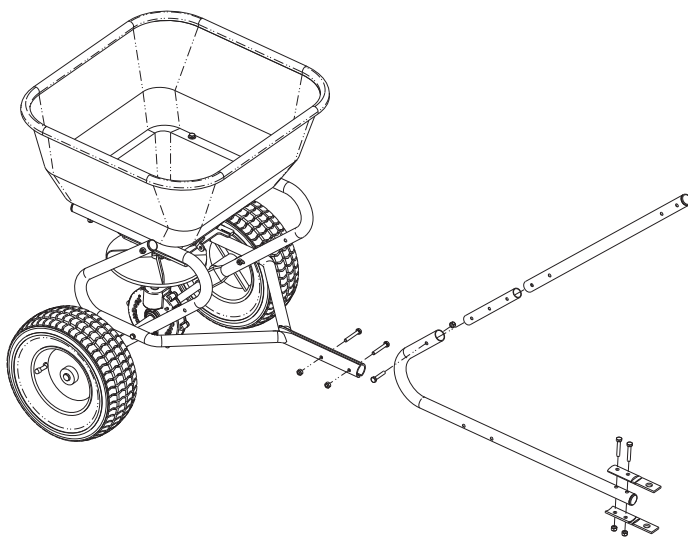

Figure 4

THIRD: ATTACH LINKAGE PLATE ASSEMBLY TO THE FRAME AS SHOWN

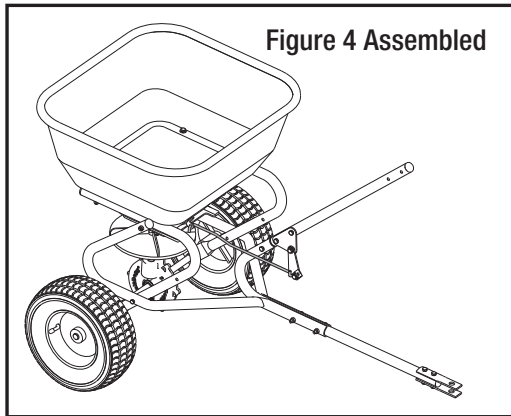
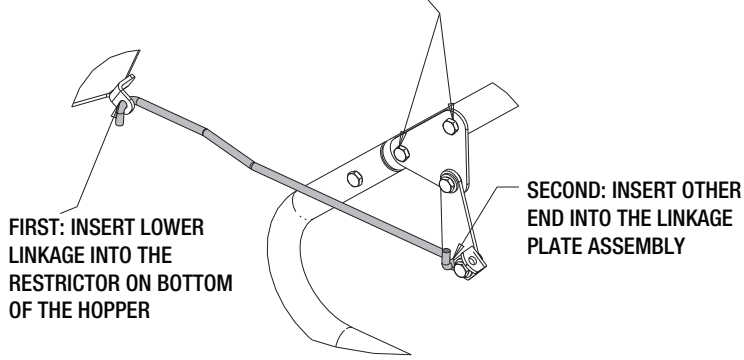

Figure 5

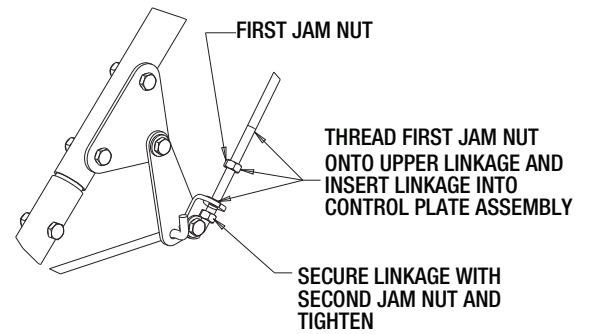
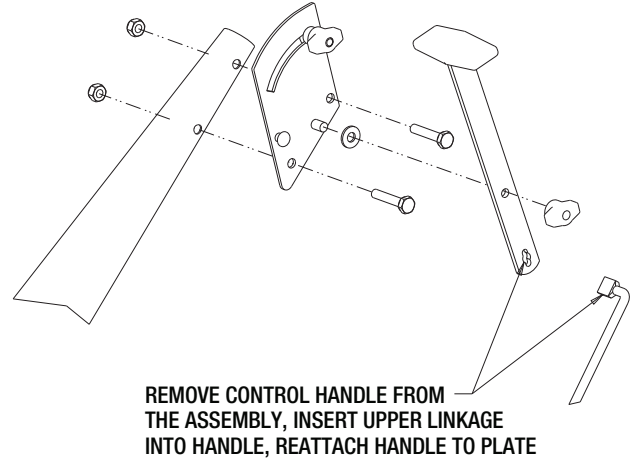
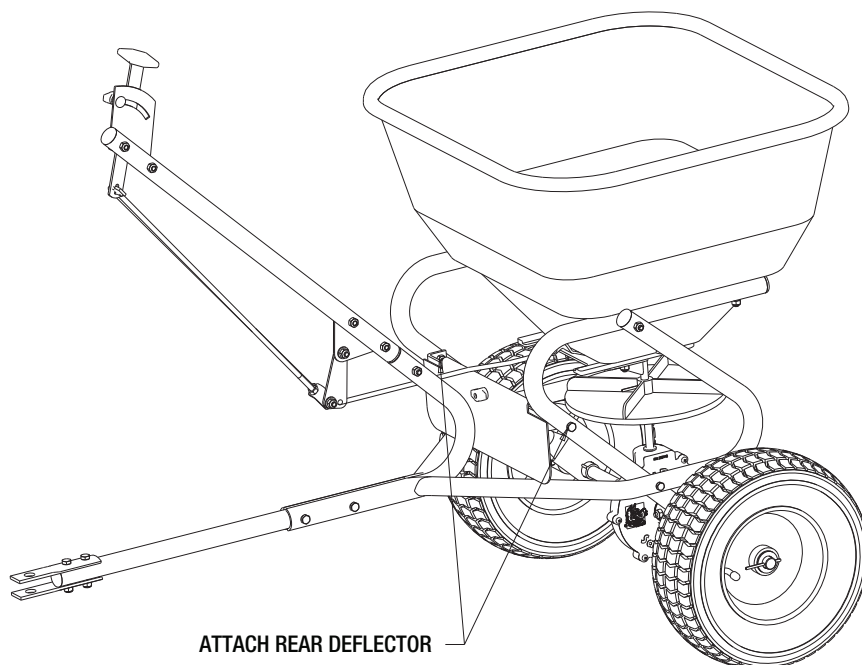
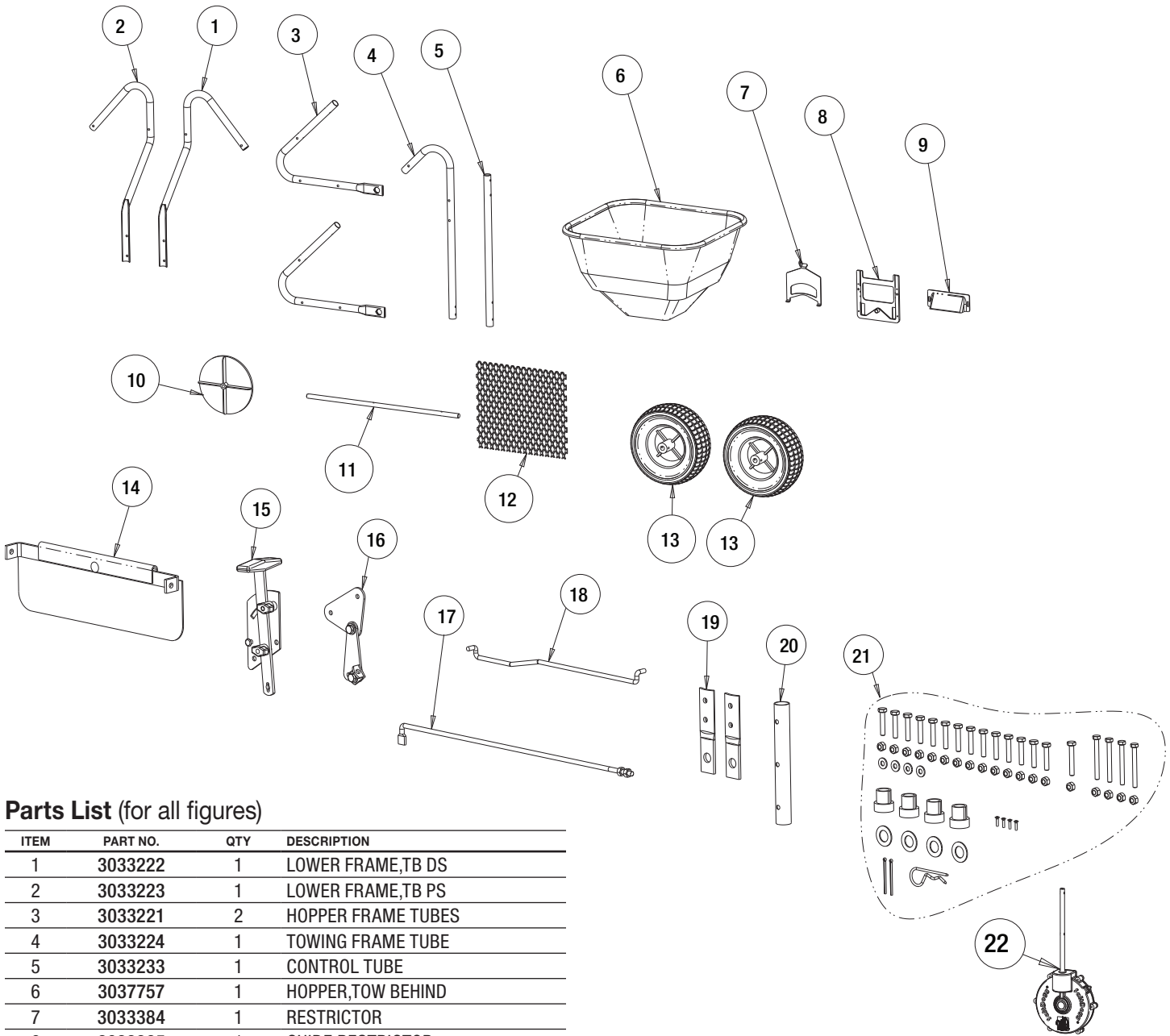

Figure 6





Parts List (for all figures)

ITEM	PART NO.	QTY	DESCRIPTION
1	3033222	1	LOWER FRAME, TB DS
2	3033223	1	LOWER FRAME, TB PS
3	3033221	2	HOPPER FRAME TUBES
4	3033224	1	TOWING FRAME TUBE
5	3033233	1	CONTROL TUBE
6	3037757	1	HOPPER, TOW BEHIND
7	3033384	1	RESTRICTOR
8	3033385	1	GUIDE, RESTRICTOR
9	3033235	1	CHUTE
10	3012696	1	SPINNER
11	3033226	1	AXLE, TOW BEHIND
12	3008813	1	SCREEN
13	3014857	2	WHEEL
14	3033227	1	REAR DEFLECTOR, TOW BEHIND
15	3009160	1	CONTROL HANDLE ASSEMBLY
16	3010878	1	LINKAGE PLATE ASSEMBLY
17	3010880	1	UPPER LINKAGE
18	3033229	1	LOWER LINKAGE, TOW BEHIND
19	3033225	2	TOWING BRACKETS
20	3033232	1	FRAME CONNECTOR
21	3033234	1	HARDWARE BAG, TOW BEHIND
22	3027118	1	GEARBOX
-	3007993	1	RAIN COVER (NOT SHOWN)

FULL ONE YEAR WARRANTY
 Manufacturer will repair, or at manufacturer's discretion will replace any part of this salt spreader which proves to be defective in workmanship or material under normal use for a period of one year from the date of delivery to the original purchaser. Any cost incurred in returning the product to the supplier is the responsibility of the consumer.

EXCLUSIONS
 Manufacturer shall not be liable for special, incidental, or consequential damages, or for damages resulting from lack of necessary maintenance, from misuse, abuse, acts of God, or alteration of the product. Some states do not allow the exclusion or limitation of incidental or consequential damages, so the above limitation or exclusion may not apply to you.